

REAR RACK QUICK START

TOOLS REQUIRED	INCLUDED
4mm allen key	(4) 4mm screws
5mm allen key	(4) 5mm screws
Adjustable Crescent Wrench	Extended Light Cable
	Zip Ties

STEP 1: REMOVE THE TAILLIGHT PLATE & TAILLIGHT

- a** Follow the cable from the taillight, cut the zip ties and pull apart the quick plug connection.
- b** Using a 4mm allen key, unscrew the allen bolts connecting the plate to the frame of the bike.
- c** Once the plate is removed, use an adjustable crescent wrench to remove the bolts holding the light onto the light plate.

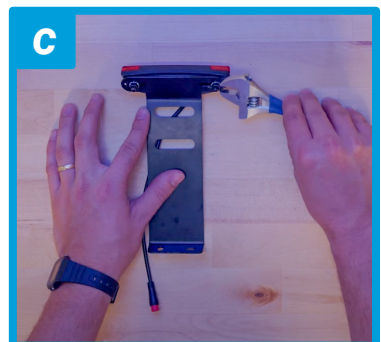

STEP 2: MOUNT REAR RACK

- a** Line up the holes of the Rear Rack with the mounting holes in the bike frame. You will use a 5mm allen key to mount the rear rack.

Screw in the 5mm screws in diagonal intervals:

- b** Begin tightening the bolt on the **right** side of the wheel as you tighten the bolt **left** of where the taillight was originally mounted. Tighten these halfway.
- c** Insert the bolts on the **left** side of the wheel and the **right** side of the taillight mounting point and tighten these halfway.
- d** Continue tightening the bolts in intervals diagonally to secure the Rear Rack straight.



STEP 3: MOUNT TAILLIGHT TO RACK

- a** Using the two 5mm bolts on the back of the taillight, mount the light to the bracket on the back of the Rear Rack.
- b** Attach the Extended Light Cable to the taillight.
- c** Then attach the other end of the Extended Light Cable to the quick plug coming out of the bike.
- d** Zip tie the cable to secure it along the grooves on the inner side of the Rear Rack and then on the grooves on the frame of the bike.

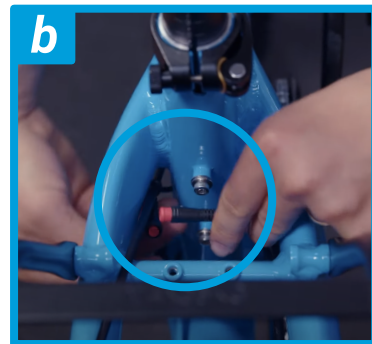
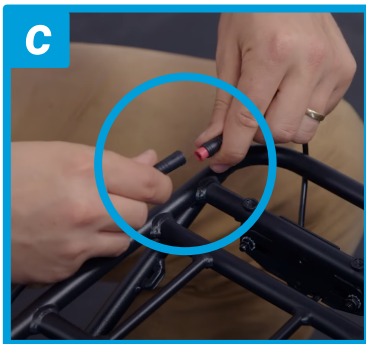

**SCAN FOR
INSTALLATION
VIDEO**